Mahan Rykiel Associates, Inc.
Landscape Architecture, Urban Design and Planning



800 Wyman Park Drive, Ste. 100 • Baltimore, MD 21211 • 410.235.6001 • 410.235.6002 (Fax)
www.mahanrykiel.com

Mahan Rykiel Associates, Inc.

University of Maryland Medical Center
Weinberg Addition, Interior Healing
Garden, Surgical Waiting Area and Atrium
Baltimore, Maryland

An impressive new addition to the University of Maryland Medical Center downtown Baltimore campus is the 375,000-square-foot Harry and Jeanette Weinberg Building. Designed by Kohn Pedersen Fox as design architect, Perkins+Will as medical planner, DCI as architect of record, and Mahan Rykiel Associates as landscape architect, the striking, modern structure houses new and expanded facilities for cancer patients,

adult and pediatric emergency departments, diagnostic imaging, food court, chapel, patient resource center and employee learning center. Its innovative architecture is matched by outstanding landscape architecture in its interior healing garden, surgical waiting areas and seven-story atrium spanning the space between the new building and an adjacent older one. The interior landscaping features seating clusters divided by trees and

low plantings. Raised planting areas create the soil depth necessary for tree plantings, define seating clusters, and suggest privacy for visitors. Tree species were selected for their ability to form spaces or create screening from above. Located near surgical suites, these planted waiting areas offer a gentle respite from

the stressful hospital environment. In evaluating the landscape design, Jeni Wright, the Center's project manager, remarked, "Its success can be measured by the use it receives from staff, patients and visitors."

Below left: Atrium
Below: Sitting area in atrium
Bottom: Healing garden
Photography: Patrick Ross



Mahan Rykiel Associates, Inc.

Kennedy Krieger Institute
Outpatient Center, Therapeutic Garden
Baltimore, Maryland

Improving the lives of children and adolescents with brain and spinal cord disorders and injuries since 1937, Baltimore's Kennedy Krieger Institute serves over 13,000 individuals annually through inpatient and outpatient clinics, home and community services and school-based programs. Its new Harry and Jeanette Weinberg Outpatient Center is a six-story, 15,000-square-foot facility, designed by Stanley Beaman Sears with Mahan Rykiel Associates as landscape architect, which consolidates all outpatient services. The sleek and largely transparent structure and graceful, oasis-like therapeutic garden simultaneously supports the programs of the clinical staff and showcases the facility's mission to the community. A gracefully curving fountain wall defines the 20,000 square foot

garden which is comprised of smaller walled 'rooms' designed for individuals and small groups. Among the many features of the garden are multi-seasonal plantings, grading challenges such as steps and ramps, and varied paving materials designed to stimulate the senses and provide opportunities for real-life mobility conditions. Water features which encourage playful interaction are accessible to children and to individuals in wheelchairs. Karen Good, Kennedy Krieger's manager of training and clinical education, applauds the garden's scheme, saying, "Therapists are natural explorers; they are accustomed to using their environment. I think a therapist will look at this and know exactly what to do with it."

Clockwise from right: Aerial view, active play area, evening view of building and garden, child and parent at fountain
Photography: Kennedy Krieger Institute, Jim Roof/Stanley Beaman Sears



Mahan Rykiel Associates, Inc.

Mercy Medical Center
Mary Catherine Bunting Center at Mercy
Baltimore, Maryland



Among the amenities awaiting patients, families and staff at Mercy Medical Center's new 18-story, 686,000-square-foot Mary Catherine Bunting Center, on Mercy's downtown Baltimore campus, are three rooftop gardens. Program elements included providing outdoor places of respite for hospital staff, visitors and patients, and coordinating

these spaces with appropriate clinical units in the facility. Designed by Ellerbe Becket with Mahan Rykiel Associates as landscape architects, the roof gardens beautifully satisfy this program element, but the team faced a number of challenges in doing so. Located on the 8th (maternity) and 9th (ICU) floors, the gardens provide generous

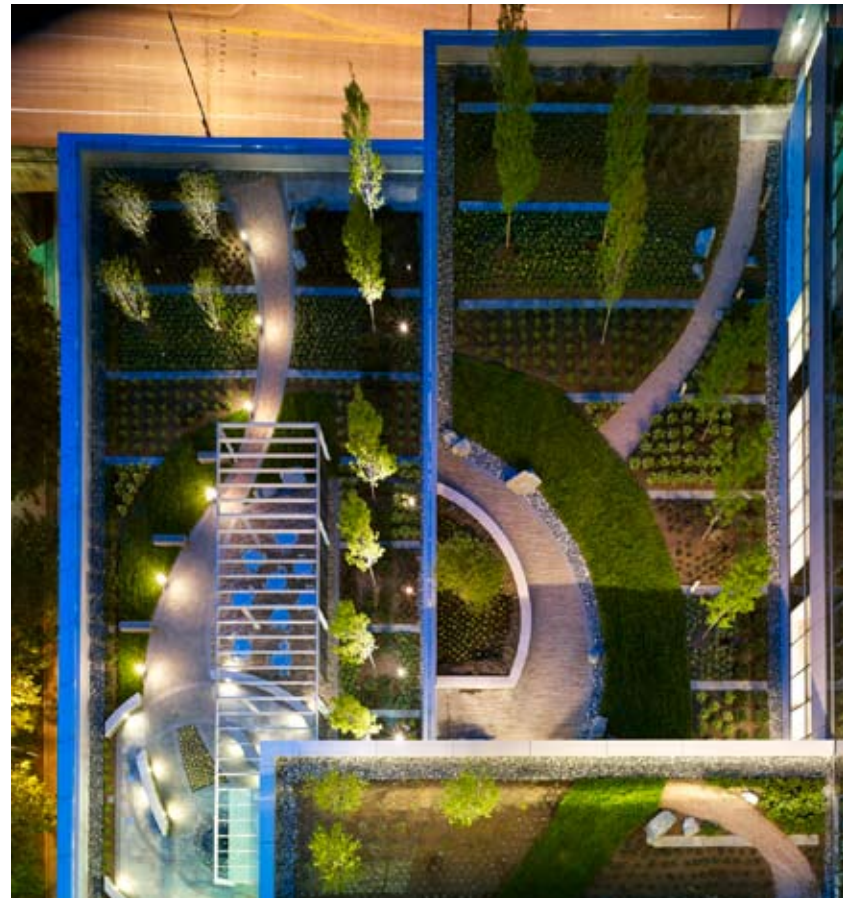

usable space but also required careful planting and berming to shield adjacent patient rooms from visitors to the garden. Other considerations included creating areas with sufficient soil depth for tree plantings and on-going coordination with structural engineers. As it implements a long-range strategic plan for campus modernization,

Mercy Medical Center, a Catholic healthcare facility and teaching hospital for the University of Maryland School of Medicine founded in 1874, has generously planted gardens where a parking garage once stood.

Clockwise from top right: 8th-floor gazebo, aerial view of 8th and 9th floors, street perspective of building and gardens, 8th floor garden in evening view
Photography: Patrick Ross
Illustration: Courtesy of Ellerbe Becket

Mahan Rykiel Associates, Inc.

Anne Arundel Medical Center
Healing Garden and Koi Pond
Annapolis, Maryland



Many regional medical centers started life at or near their communities' centers, including Anne Arundel Medical Center, founded in downtown Annapolis, Maryland in 1902. However, when the hospital consolidated acute care services in 2001, it relocated to an all-new facility at its suburban Medical Park campus. Among the amenities at the new 316-bed, six-story, 330,000-square-foot Acute Care Pavilion, designed by Wheeler Goodman Masek with Mahan Rykiel Associates as landscape architect, are a healing garden, near the main and ER entrances, and a koi pond, the focal point of the cafeteria garden. The

award-winning landscape blends form and function seamlessly. For example, the walkway in the healing garden's narrow, linear space—too tight for a full loop path—diverges in places so visitors need not pass each other, preserving their privacy. Similarly, a rocky stream winds through natural-looking plantings to provide a visible symbol of healing that generates the calming sound of water and thrives as a wildlife habitat. With an entrance only from the building, security cameras disguised as birdhouses and a strategically placed brick wall, the healing garden enjoys visibility with security.

At the Koi Pond, an etched glass railing gives the names of donors subtle prominence. Happily, the hospital's beloved fish are flourishing in their new pond in Medical Park.

Clockwise from below center: Koi Pond planting edge, birds, koi, rocky stream, seating area, view from the cafeteria
Photography: Patrick Mullaly, Joseph Augstein

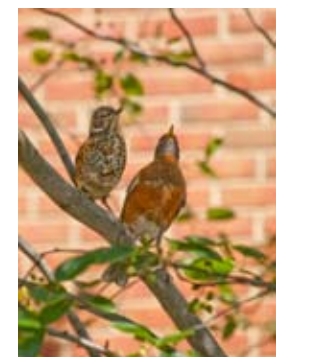
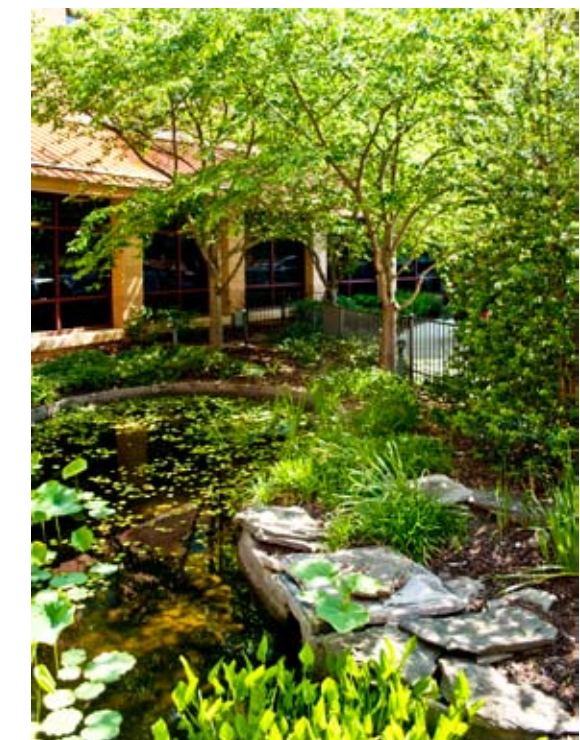

Mahan Rykiel Associates, Inc.

Providence Hospital
Healing Garden
Washington, D.C.

Chartered by Abraham Lincoln in 1861, 480-bed Providence Hospital is the longest continuously operating hospital in Washington, D.C. and a vital component of Ascension Health, the nation's largest Catholic health system. The venerable institution willingly courts fresh ideas, nonetheless. Its new healing garden, designed by Mahan Rykiel Associates, addresses the needs of the community teaching hospital by providing a meditative outdoor space that simultaneously offers respite from stress and space for outdoor activities such as music concerts and yoga and tai chi classes. A decorative iron picket fence encloses the mostly linear space, and separates the garden from the everyday activity at the hospital's main entrance. The garden is configured as a series of pathways and places with fountains as focal points, seating along the way, a central area with an open lawn, and smaller, contemplative areas that are encircled and protected by lush planting. The garden is presented as a welcoming environment that cleanses, protects and nurtures its occupants. "The garden has been a great success and has

been well used by staff, patients and visitors," reports Providence's Thomas Anderson, vice president for facilities management. "We receive many compliments on the garden."

Right: Planting bed and pathway
Below: Fountain and exercise class
Below right: Detail of fountain
Photography: Patrick Ross, Joseph Augstein, G.W. Meredith



Mahan Rykiel Associates, Inc.

Essex County Hospital Center
Cedar Grove, New Jersey



Above: Ramp and stairs in courtyard
Above right: Courtyard
Right: Entry plaza
Photography: Courtesy of Cannon Design



Advances in the medical treatment of mental illness beginning in the 1960s are dramatically portrayed in the newest home of Essex County Hospital Center, in Cedar Grove, New Jersey. A 180-bed, 154,000-square-foot county hospital that houses mentally ill patients, was designed by Cannon Design with Mahan Rykiel Associates as landscape architect. The new construction replaces a much smaller predecessor from 1897. The landscape development of the hospital and its 11-acre campus represented a considerable challenge despite its modern, safe and serene image, due to steep grades across the site, specific outdoor activities that required flat grades, and the need for accessibility. The Hospital Center comprises five interconnected buildings that allow staff and patients to walk throughout the facility without going outside. Indoor spaces include an all-purpose room, residential units, treatment mall and education facilities. Outdoor facilities, include a half-acre courtyard, a greenhouse for therapy, a basketball court, active recreation areas and passive meditative spaces. Careful contouring of the grounds thoughtfully integrates the architectural geometry into the site and creates a series of spaces that enhance the ability of the hospital to serve another century of patients.



Mahan Rykiel Associates, Inc.

Master Planning
Fort Benning Replacement Hospital,
Fort Benning, Georgia
Tawam Hospital Master Plan,
Al Aain, Abu Dhabi
St. Luke's Healthcare Village Master Plan
Bethlehem, Pennsylvania



Crafting a workable vision for long-term development forms the core of Mahan Rykiel Associates' master planning for medical campuses. A successful master plan, as created by Mahan Rykiel Associates, is a flexible framework for development that will be implemented over time. Their master plans are based on a thorough understanding of clients' goals tempered by an evaluation of the opportunities and challenges of specific sites. Thus, the master plan

for Fort Benning's replacement hospital, designed by Ellerbe Becket (AECOM) with Mahan Rykiel Associates, places a high priority on the beautifully wooded site overlooking the Marne River, in Fort Benning, Georgia, and focuses the entry, patient tower, lobby and dining on views of nature. Likewise, the master plan for the expansion of Tawam Hospital, in Al Aain, Abu Dhabi, developed by RTKL with Mahan Rykiel Associates, arranges the hospital, hotel/conference center, medical

school and other components on either side of a huge, river-like water feature. By contrast, landscape amenities introduce village-like characteristics in the master plan for St. Luke's Hospital's Healthcare Village, in Bethlehem, Pennsylvania, a community of wellness where a 600-bed hospital will be accompanied by medical office buildings and support services such as offices, retailing, housing and a hotel/conference center.



Above: St. Luke's Healthcare Village Master Plan

Upper left: Fort Benning Master Plan

Left: Tawam Hospital Master Plan

Illustration: Courtesy of Mahan Rykiel Associates